

RoHS

This products can apply to the SWB Doc NO. QA-3-04-005 of Environmental&Material Management Rules



■ Specifications :

- Voltage rating: 250V AC / DC
- Current rating: 3A AC / DC
- Withstanding voltage: 1500V AC/minute
- Temperature range: -25°C~+85°C
- Insulation resistance:≥1000MΩ
- Contact resistance: ≤20mΩ
- After environmental testing: ≤30mΩ
- Suitable SWB Terminal:9555T-A
- Mates With SWB Wafer: 9555W

9555 H X-2*XX C2-PT XX

① ②③ ④ ⑤ ⑥ ⑦

- ① Series No.
- ② Category: H-HSG
- ③ Welding Board Angle: Blank-ordinary
- ④ Row No.-Pin No.: 2*XX-2*02P~2*32P
- ⑤ Special No. : C2-Unnotched;Double convex
- ⑥ Material: PT-PBT 94V-0
- ⑦ Color: Blank-Natural Color

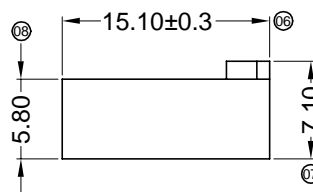
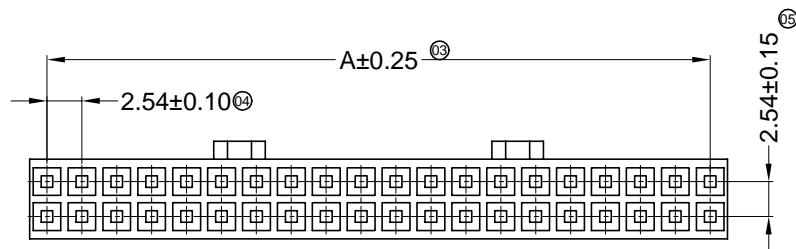
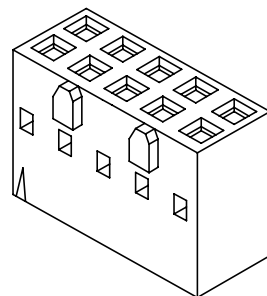
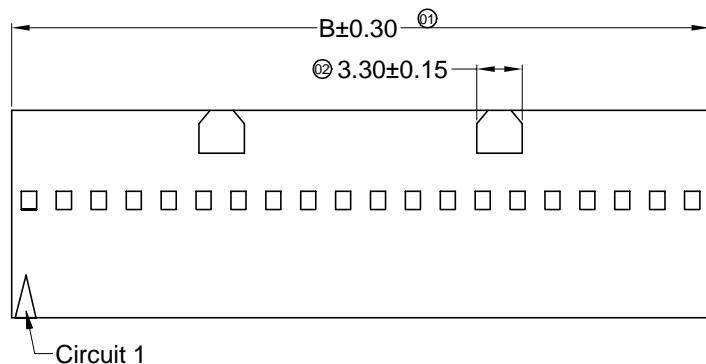

| Poles | Dimensions (mm) | | Poles | Dimensions (mm) | | Poles | Dimensions (mm) | |
|-------|-----------------|-------|-------|-----------------|-------|-------|-----------------|-------|
| | A | B | | A | B | | A | B |
| 2*02 | 2.54 | 5.05 | 2*13 | 30.48 | 32.99 | 2*24 | 58.42 | 60.93 |
| 2*03 | 5.08 | 7.59 | 2*14 | 33.02 | 35.53 | 2*25 | 60.96 | 63.47 |
| 2*04 | 7.62 | 10.13 | 2*15 | 35.56 | 38.07 | 2*26 | 63.50 | 66.01 |
| 2*05 | 10.16 | 12.67 | 2*16 | 38.10 | 40.61 | 2*27 | 66.04 | 68.55 |
| 2*06 | 12.70 | 15.21 | 2*17 | 40.64 | 43.15 | 2*28 | 68.58 | 71.09 |
| 2*07 | 15.24 | 17.75 | 2*18 | 43.18 | 45.69 | 2*29 | 71.12 | 73.63 |
| 2*08 | 17.78 | 20.29 | 2*19 | 45.72 | 48.23 | 2*30 | 73.66 | 76.17 |
| 2*09 | 20.32 | 22.83 | 2*20 | 48.26 | 50.77 | 2*31 | 76.20 | 78.71 |
| 2*10 | 22.86 | 25.37 | 2*21 | 50.80 | 53.31 | 2*32 | 78.74 | 81.25 |
| 2*11 | 25.40 | 27.91 | 2*22 | 53.34 | 55.85 | | | |
| 2*12 | 27.94 | 30.45 | 2*23 | 55.88 | 58.39 | | | |

| | | | | | | | | | | | | | | | |
|------------|-----|---------------|-----------------------------|---------|----------|--|--|-----|---------|------------|-----------------------------|-------|-------|-----|---|
| 2020/08/07 | E | | Update Drawing Frame | Roy | Robing | GENERAL TOLERANCE .X ±0.35 .XX ±0.25 .XXX ±0.15 X.° ±2° PROJECT | 东莞市思索连接器有限公司 SWB CONNECTORS CO.,LTD | | | | PART NO. 9555H-2*XXC2-PT | | | | |
| 2015/05/14 | D | | Modify drawing frame format | jian.He | | | | | | | APPROVAL | | | | TITLE 2.54 mm Crimp Style Connectors |
| 2013/08/16 | C | ECN2013082501 | Modify drawing frame format | Luna | | | Smark | Guo | Liu Yan | 2007/05/03 | UNIT | SCALE | SHEET | REV | NUMBER |
| DATE | REV | ECN NO | DESCRIPTION | MODIFY | APPROVAL | | | | | | mm | 1:1 | 1/1 | E | A-053 |

RoHS

This products can apply to the SWB Doc NO. QA-3-04-005 of Environmental&Material Management Rules



■ Specifications :

- Voltage rating: 250V AC / DC
- Current rating: 3A AC / DC
- Withstanding voltage: 1500V AC/minute
- Temperature range: -25°C~+85°C
- Insulation resistance: ≥1000MΩ
- Contact resistance: ≤20mΩ
- After environmental testing: ≤30mΩ
- Suitable SWB Terminal: 9555T
- Mates With SWB Wafer: 9555W

9555 H X-2*XX C1-PT XX

① ② ③ ④ ⑤ ⑥ ⑦

- ① Series No.
- ② Category: H-HSG
- ③ Welding Board Angle: Blank-ordinary
- ④ Row No.-Pin No.: 2*XX-2*02P~2*32P
- ⑤ Special No. : C1-Unnotched;Single convex
- ⑥ Material: PT-PBT 94V-0
- ⑦ Color: Blank-Natural Color

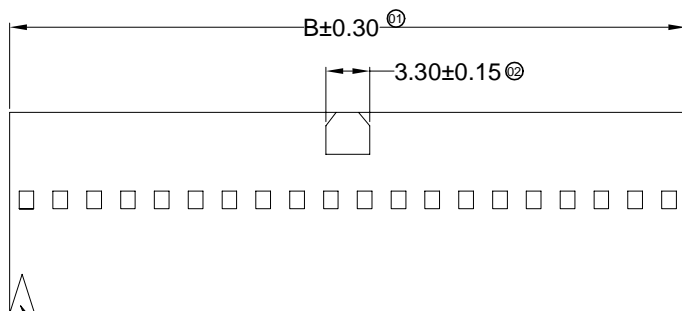

Circuit 1

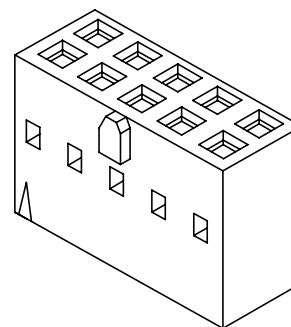
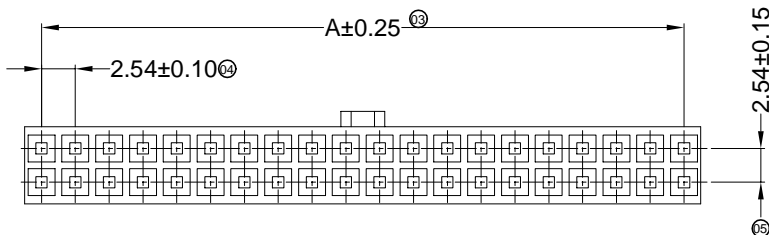
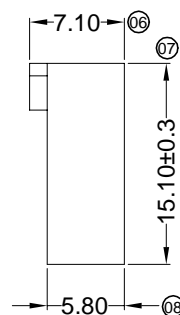

| Poles | Dimensions (mm) | | Poles | Dimensions (mm) | | Poles | Dimensions (mm) | |
|-------|-----------------|-------|-------|-----------------|-------|-------|-----------------|-------|
| | A | B | | A | B | | A | B |
| 2*02 | 2.54 | 5.05 | 2*13 | 30.48 | 32.99 | 2*24 | 58.42 | 60.93 |
| 2*03 | 5.08 | 7.59 | 2*14 | 33.02 | 35.53 | 2*25 | 60.96 | 63.47 |
| 2*04 | 7.62 | 10.13 | 2*15 | 35.56 | 38.07 | 2*26 | 63.50 | 66.01 |
| 2*05 | 10.16 | 12.67 | 2*16 | 38.10 | 40.61 | 2*27 | 66.04 | 68.55 |
| 2*06 | 12.70 | 15.21 | 2*17 | 40.64 | 43.15 | 2*28 | 68.58 | 71.09 |
| 2*07 | 15.24 | 17.75 | 2*18 | 43.18 | 45.69 | 2*29 | 71.12 | 73.63 |
| 2*08 | 17.78 | 20.29 | 2*19 | 45.72 | 48.23 | 2*30 | 73.66 | 76.17 |
| 2*09 | 20.32 | 22.83 | 2*20 | 48.26 | 50.77 | 2*31 | 76.20 | 78.71 |
| 2*10 | 22.86 | 25.37 | 2*21 | 50.80 | 53.31 | 2*32 | 78.74 | 81.25 |
| 2*11 | 25.40 | 27.91 | 2*22 | 53.34 | 55.85 | | | |
| 2*12 | 27.94 | 30.45 | 2*23 | 55.88 | 58.39 | | | |

| | | | | | | | | | | | | | | | |
|------------|-----|---------------|-----------------------------|---------|----------|---|--|-----|---------|------------|-----------------------------|-------|-------|-----|---|
| 2020/08/07 | E | | Update Drawing Frame | Roy | Robing | GENERAL TOLERANCE .X ±0.35 .XX ±0.25 .XXX ±0.15 X.° ±2° PROJECT | 东莞市思索连接器有限公司 SWB CONNECTORS CO.,LTD | | | | PART NO. 9555H-2*XXC1-PT | | | | |
| 2015/05/13 | D | | Modify drawing frame format | jian.He | | | | | | | APPROVAL | | | | TITLE 2.54 mm Crimp Style Connectors |
| 2013/08/16 | C | ECN2013082501 | Modify drawing frame format | Luna | | | Smark | Guo | Liu Yan | 2007/05/03 | UNIT | SCALE | SHEET | REV | NUMBER |
| DATE | REV | ECN NO | DESCRIPTION | MODIFY | APPROVAL | | | | | | mm | 1:1 | 1/1 | E | A-053 |

RoHS

This products can apply to the SWB Doc NO. QA-3-04-005 of Environmental&Material Management Rules



■ Specifications :

- Voltage rating: 250V AC / DC
- Current rating: 3A AC / DC
- Withstanding voltage: 1500V AC/minute
- Temperature range: -25°C~+85°C
- Insulation resistance: ≥1000MΩ
- Contact resistance: ≤20mΩ
- After environmental testing: ≤30mΩ
- Suitable SWB Terminal: 9555T
- Mates With SWB Wafer: 9555W

9555 H X-2*XX CA-PT XX

① ②③ ④ ⑤ ⑥ ⑦

- ① Series No.
- ② Category: H-HSG
- ③ Welding Board Angle: Blank-ordinary
- ④ Row No.-Pin No.: 2*XX-2*02P~2*32P
- ⑤ Special No. : CA-unnotched;Without raised;
Triangle icon in the lower right corner
- ⑥ Material: PT-PBT 94V-0
- ⑦ Color: Blank-Natural Color

<04P-20P> B±0.30
<22P-40P> B±0.40
<42P-64P> B±0.50

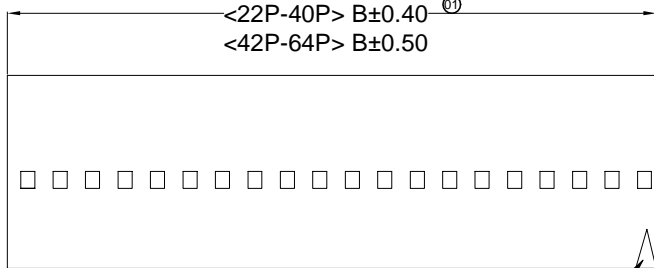

Circuit 1

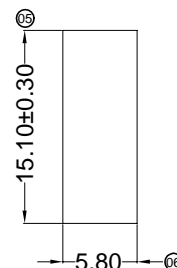

<04P-20P> A±0.25
<22P-40P> A±0.35
<42P-64P> A±0.45

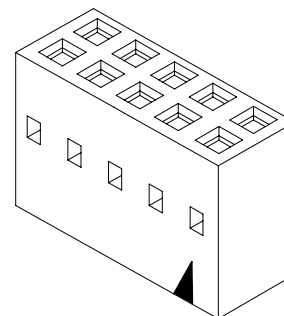
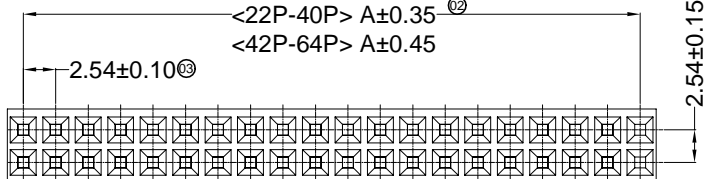

| Poles | Dimensions (mm) | | Poles | Dimensions (mm) | | Poles | Dimensions (mm) | |
|-------|-----------------|-------|-------|-----------------|-------|-------|-----------------|-------|
| | A | B | | A | B | | A | B |
| 2*02 | 2.54 | 5.05 | 2*13 | 30.48 | 32.99 | 2*24 | 58.42 | 60.93 |
| 2*03 | 5.08 | 7.59 | 2*14 | 33.02 | 35.53 | 2*25 | 60.96 | 63.47 |
| 2*04 | 7.62 | 10.13 | 2*15 | 35.56 | 38.07 | 2*26 | 63.50 | 66.01 |
| 2*05 | 10.16 | 12.67 | 2*16 | 38.10 | 40.61 | 2*27 | 66.04 | 68.55 |
| 2*06 | 12.70 | 15.21 | 2*17 | 40.64 | 43.15 | 2*28 | 68.58 | 71.09 |
| 2*07 | 15.24 | 17.75 | 2*18 | 43.18 | 45.69 | 2*29 | 71.12 | 73.63 |
| 2*08 | 17.78 | 20.29 | 2*19 | 45.72 | 48.23 | 2*30 | 73.66 | 76.17 |
| 2*09 | 20.32 | 22.83 | 2*20 | 48.26 | 50.77 | 2*31 | 76.20 | 78.71 |
| 2*10 | 22.86 | 25.37 | 2*21 | 50.80 | 53.31 | 2*32 | 78.74 | 81.25 |
| 2*11 | 25.40 | 27.91 | 2*22 | 53.34 | 55.85 | | | |
| 2*12 | 27.94 | 30.45 | 2*23 | 55.88 | 58.39 | | | |

| | | | | | | | | | | | | | | | |
|------------|-----|---------------|-----------------------------|--------|------------|-------------------|--|-------|---------|-----------------------------|---|-----|-----|---|-------|
| 2020/08/07 | E | | Update Drawing Frame | Roy | Robing | GENERAL TOLERANCE | | | | PART NO. 9555H-2*XXCA-PT | | | | | |
| 2015/05/12 | D | | Modify the LOGO | sylvia | | .X ±0.35 | 东莞市思索连接器有限公司 SWB CONNECTORS CO.,LTD | | | | TITLE 2.54 mm Crimp Style Connectors | | | | |
| 2013/08/16 | C | ECN2013082501 | Modify drawing frame format | Luna | .XX ±0.25 | | | | | | | | | | |
| | | | | | .XXX ±0.15 | | | | | | | | | | |
| | | | | | | X.° ±2° | APPROVAL | CHECK | DRAWN | DATE | UNIT SCALE SHEET REV NUMBER | | | | |
| DATE | REV | ECN NO | DESCRIPTION | MODIFY | APPROVAL | PROJECT | Smark | Guo | Liu Yan | 2007/05/03 | mm | 1:1 | 1/1 | E | A-053 |

RoHS

This products can apply to the SWB Doc NO. QA-3-04-005 of Environmental&Material Management Rules

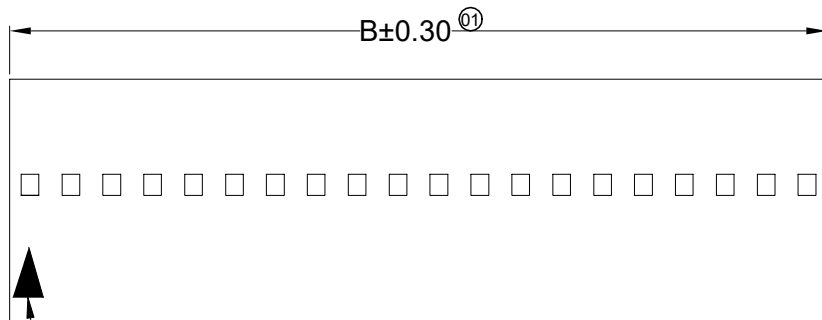

Circuit 1

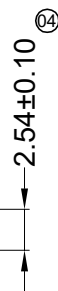
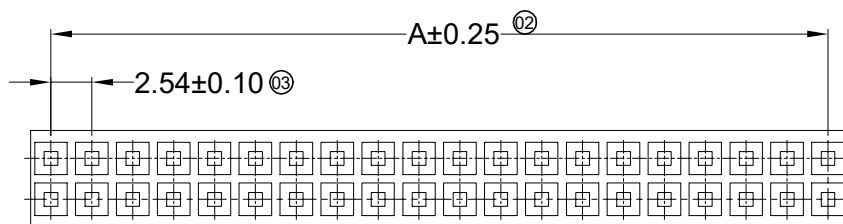
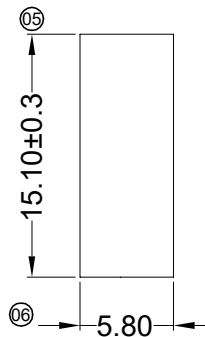

■ Specifications :

- Voltage rating: 250V AC / DC
- Current rating: 3A AC / DC
- Withstanding voltage: 1500V AC/minute
- Temperature range: -25°C~+85°C
- Insulation resistance: ≥1000MΩ
- Contact resistance: ≤20mΩ
- After environmental testing: ≤30mΩ
- Suitable SWB Terminal: 9555T
- Mates With SWB Wafer: 9555W

9555 H X-2*XX C-PT XX

① ② ③ ④ ⑤ ⑥ ⑦

- ① Series No.
- ② Category: H-HSG
- ③ Welding Board Angle: Blank-ordinary
- ④ Row No.-Pin No.: 2*XX-2*02P~2*32P
- ⑤ Special No. : C-unnotched;Without raised;
- ⑥ Material: PT-PBT 94V-0
- ⑦ Color: Blank-Natural Color

| Poles | Dimensions (mm) | | Poles | Dimensions (mm) | | Poles | Dimensions (mm) | |
|-------|-----------------|-------|-------|-----------------|-------|-------|-----------------|-------|
| | A | B | | A | B | | A | B |
| 2*02 | 2.54 | 5.05 | 2*13 | 30.48 | 32.99 | 2*24 | 58.42 | 60.93 |
| 2*03 | 5.08 | 7.59 | 2*14 | 33.02 | 35.53 | 2*25 | 60.96 | 63.47 |
| 2*04 | 7.62 | 10.13 | 2*15 | 35.56 | 38.07 | 2*26 | 63.50 | 66.01 |
| 2*05 | 10.16 | 12.67 | 2*16 | 38.10 | 40.61 | 2*27 | 66.04 | 68.55 |
| 2*06 | 12.70 | 15.21 | 2*17 | 40.64 | 43.15 | 2*28 | 68.58 | 71.09 |
| 2*07 | 15.24 | 17.75 | 2*18 | 43.18 | 45.69 | 2*29 | 71.12 | 73.63 |
| 2*08 | 17.78 | 20.29 | 2*19 | 45.72 | 48.23 | 2*30 | 73.66 | 76.17 |
| 2*09 | 20.32 | 22.83 | 2*20 | 48.26 | 50.77 | 2*31 | 76.20 | 78.71 |
| 2*10 | 22.86 | 25.37 | 2*21 | 50.80 | 53.31 | 2*32 | 78.74 | 81.25 |
| 2*11 | 25.40 | 27.91 | 2*22 | 53.34 | 55.85 | | | |
| 2*12 | 27.94 | 30.45 | 2*23 | 55.88 | 58.39 | | | |



| | | | | | | | | | | | | | | | | | | | |
|------------|-----|---------------|-----------------------------|--------|----------|-------------------|---|--|--|--|---|--|--|--|--|----------|-------|---------|------------|
| 2020/08/07 | D | | Update Drawing Frame | Roy | Robing | GENERAL TOLERANCE |  东莞市思索连接器有限公司 SWB CONNECTORS CO.,LTD | | | | PART NO. 9555H-2*XXC-PT | | | | | | | | |
| 2013/08/16 | C | ECN2013082501 | Modify drawing frame format | Luna | | .X ±0.35 | | | | | TITLE 2.54 mm Crimp Style Connectors | | | | | | | | |
| 2011/09/08 | B | | Modify drawing frame format | | | .XX ±0.25 | | | | | | | | | | APPROVAL | CHECK | DRAWN | DATE |
| DATE | REV | ECN NO | DESCRIPTION | MODIFY | APPROVAL | X.° ±2° | | | | | | | | | | Smark | Guo | Liu Yan | 2007/05/03 |
| | | | | | | PROJECT | UNIT SCALE SHEET REV NUMBER mm 1:1 1/1 D A-053 | | | | | | | | | | | | |

RoHS

This products can apply to the SWB Doc NO. QA-3-04-005 of Environmental&Material Management Rules

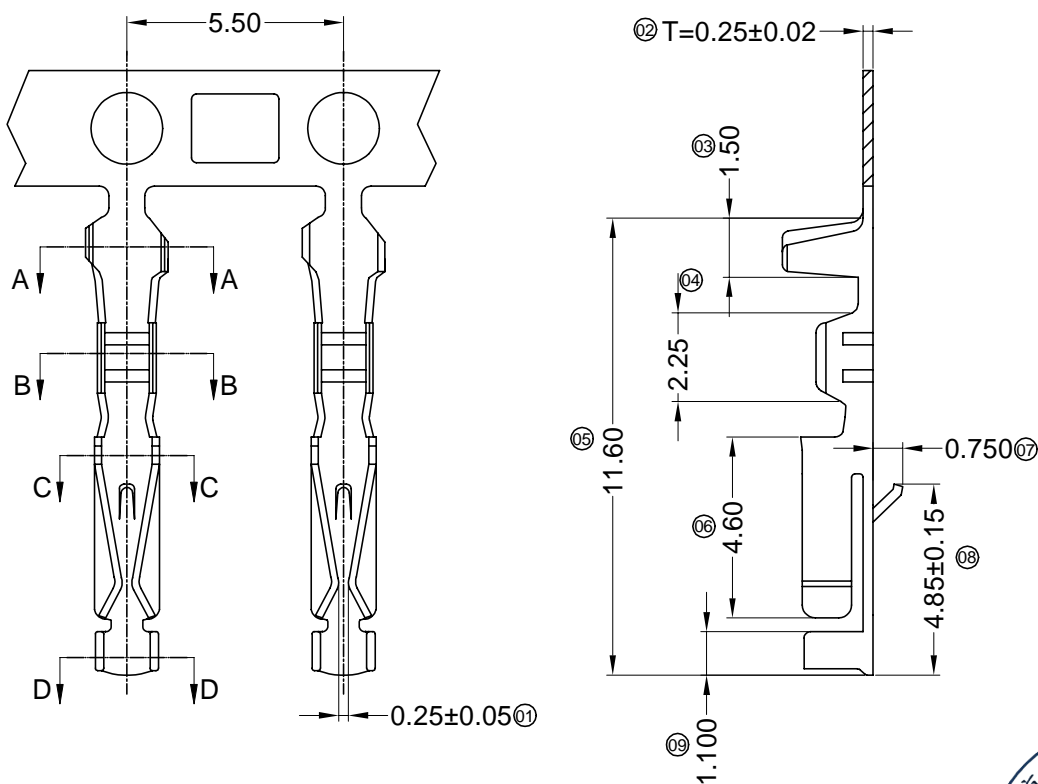

■ Specifications :

- Voltage rating: 250V AC / DC
- Current rating: 3A AC / DC
- Withstanding voltage: 1500V AC/minute
- Temperature range: -25°C~+85°C
- Insulation resistance: ≥1000MΩ
- Contact resistance: ≤20mΩ
- After environmental testing: ≤30mΩ

9555 T X-P XX X-X
① ② ③ ④ ⑤ ⑥ ⑦

- ① Series Number
- ② Category: T-terminal
- ③ Shape: Blank-ordinary
- ④ Material: P-Phosphor bronze
- ⑤ Plating style: G01-Contact Gold Flash ; SN-Bright tin plating
- ⑥ Plating method: Blank-Stamping before plating
- ⑦ Mold No./Mark/Special No.

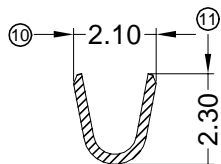

SECTION A-A
SCALE 1:1

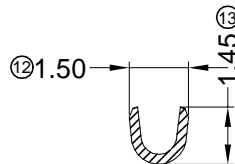

SECTION B-B
SCALE 1:1

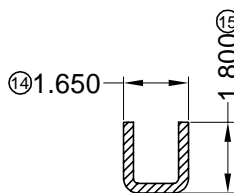

SECTION C-C
SCALE 1:1

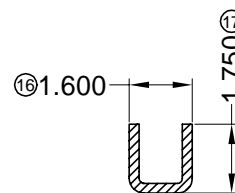

SECTION D-D
SCALE 1:1



| | | | | |
|------------|-----------------|------------|---|---------------------|
| 9555T-PG01 | Phosphor Bronze | AWG#22-28 | Stamping Before Plating:30u" Ni>Contact Area Gold Flash | 9555H-A |
| 9555T-PSN | | | Stamping Before Plating:30u" Ni;70u"Sn | |
| PART NO | Material | Wire Range | Finish | Used In SWB Housing |

| DATE | REV | ECN NO | DESCRIPTION | MODIFY | APPROVAL | GENERAL TOLERANCE | APPROVAL | | | | PART NO. | | | |
|------------|-----|-----------------------------|----------------------|--------|-----------|--|--|----------|--------|------------|----------|-----------------------|-------|-------|
| 2020/08/08 | C | | Update Drawing Frame | Roy | Robing | .X ±0.35 | 东莞市思索连接器有限公司 SWB CONNECTORS CO.,LTD | APPROVAL | CHECK | DRAWN | DATE | PART NO. 9555T-PXX | | |
| 2015/05/14 | B | Modify drawing frame format | jian.He | | .XX ±0.25 | TITLE 2.54mm Crimp Style Connectors | | | | | | | | |
| | | | | | | .XXX ±0.15 | | | | | | UNIT | SCALE | SHEET |
| | | | | | | X.° ±2° | mm | 1:1 | 1/1 | C | A-053 | | | |
| | | | | | | PROJECT | Robing | Alan Qin | sylvia | 2013/12/27 | | | | |

RoHS

This products can apply to the SWB Doc NO. QA-3-04-005 of Environmental&Material Management Rules



Specifications :

- Voltage rating: 250V AC / DC
- Current rating: 3A AC / DC
- Withstanding voltage: 1500V AC/minute
- Temperature range: -25°C~+85°C
- Insulation resistance: ≥1000MΩ
- Contact resistance: ≤20mΩ
- After environmental testing: ≤30mΩ

9555 T X-P XX X-A

① ② ③ ④ ⑤ ⑥ ⑦

- ① Series Number
- ② Category: T-terminal
- ③ Shape: Blank-ordinary
- ④ Material: P-Phosphor bronze
- ⑤ Plating Code: V**-All Gold-Plated, G-Gold-Plated Contact, *01-Gold Flash ; *03-3u" ; *05-5u" ; *15-15u" ; *30-30u" ; SN-Bright tin plating
- ⑥ Plating method: Blank-Stamping before plating
- ⑦ Mold No./Mark/Special No. A-matching 9555H-2*XX HSG

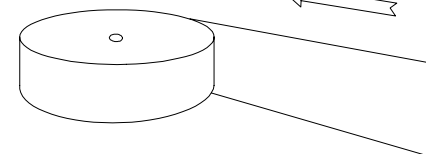

Receiving direction map after Plated (Crimp opening outwards)

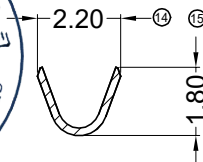
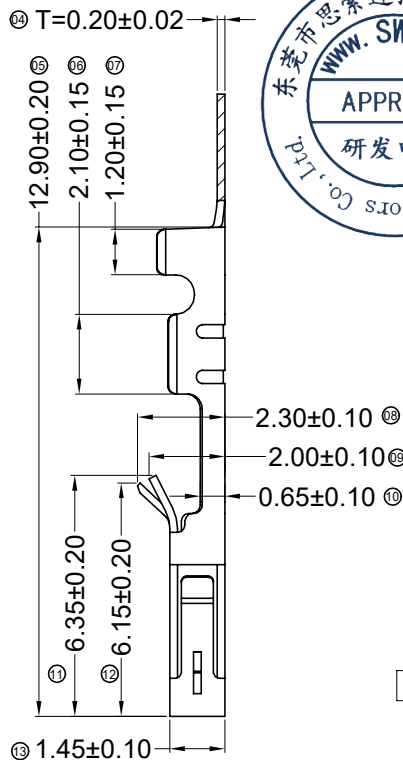
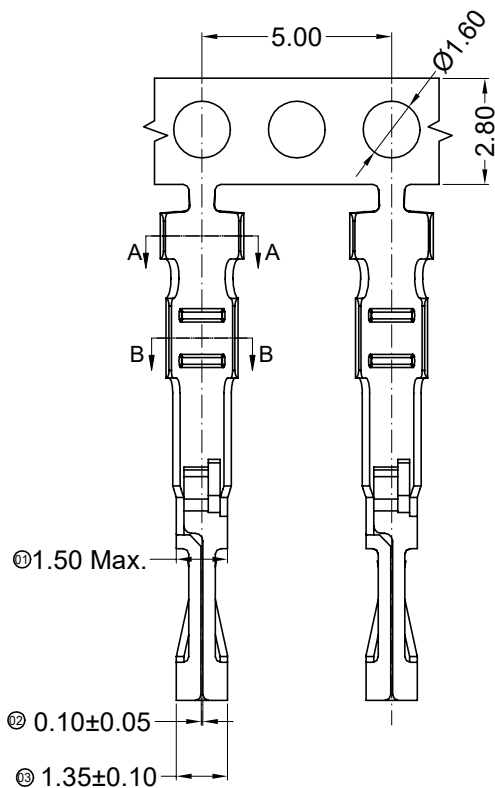

SECTION: A-A SCALE: 1:1

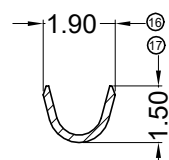

SECTION: B-B SCALE: 1:1

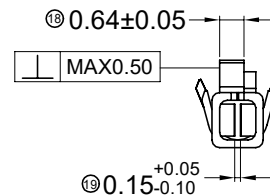

| | | | | |
|--------------|-----------------|------------|--|---------------------|
| 9555T-PG15-A | Phosphor Bronze | AWG#22-30 | Stamping Before Pating:30u" Ni;Contact Area gold:15u" Min. | 9555H |
| 9555T-PG03-A | | | Stamping Before Pating:30u" Ni;Contact Area gold:3u" Min. | |
| 9555T-PG01-A | | | Stamping Before Pating:30u" Ni;Contact Area Gold Flash | |
| 9555T-PSN-A | | | Stamping Before Plating:30u" Ni;70u"Sn | |
| PART NO | Material | Wire Range | Finish | Used In SWB Housing |

| | | | | | |
|------------|-----|--------|-----------------------------|---------|----------|
| 2020/07/22 | H | | Update Drawing Frame | Roy.Hu | Robing |
| 2015/05/14 | G | | Modify drawing frame format | jian.He | Success |
| 2013/12/12 | F | | Change ⑧⑩⑪⑫ Size | Luna | Success |
| DATE | REV | ECN NO | DESCRIPTION | MODIFY | APPROVAL |

GENERAL TOLERANCE
.X ±0.35
.XX ±0.25
.XXX ±0.15
X.° ±2°

PROJECT

APPROVAL: Success, CHECK: Sun Kaibao, DRAWN: Song Li, DATE: 2013/07/04

PART NO. 9555T-PXX-A

TITLE: 2.54 mm Crimp Style Connectors

| | | | | |
|------|-------|-------|-----|--------|
| UNIT | SCALE | SHEET | REV | NUMBER |
| mm | 1:1 | 1/1 | H | A-014 |